

YORK

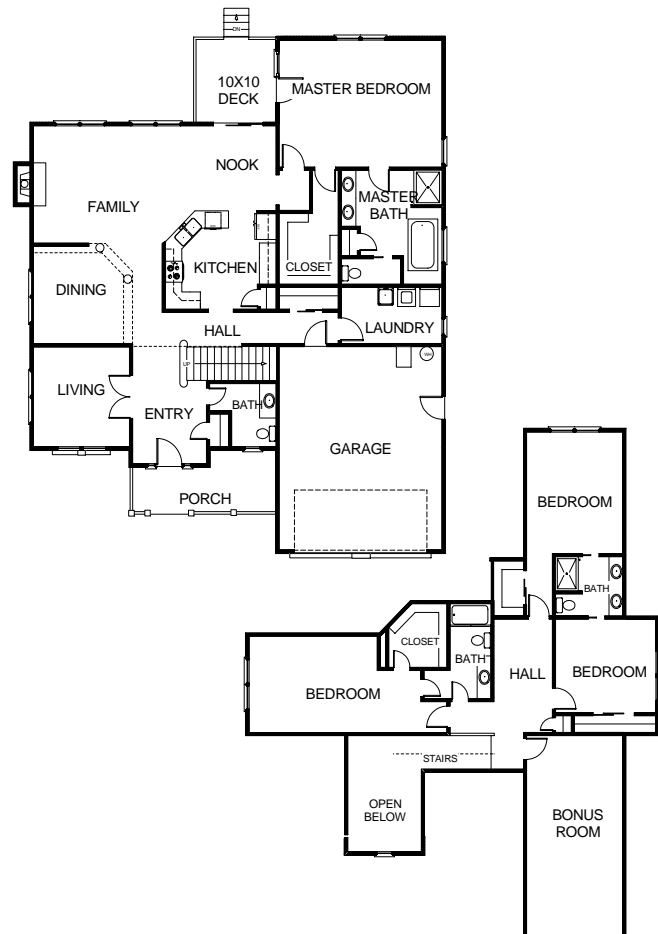

- 4 BEDROOMS
- 3.5 BATHS, INCLUDING FIRST FLOOR MASTER SUITE LUXURY BATH
- KITCHEN WITH BREAKFAST NOOK
- FAMILY ROOM
- LIVING ROOM & DINING ROOM
- LAUNDRY ROOM
- BONUS ROOM OVER 2 CAR ATTACHED GARAGE
- AVAILABLE ON CRAWL SPACE FOUNDATION ONLY
- MODEL SHOWN WITH OPTIONAL BRICK ACCENT (SEE SITE AGENT FOR PRICING)
- MODEL SHOWN WITH OPTIONAL METAL ROOF (SEE SITE AGENT FOR PRICING)
- 3,168 SQUARE FEET OF LIVING AREA



NewHomesVEI.com

ARTIST RENDERING/PHOTO AND FLOOR PLAN LAYOUT ARE FOR ILLUSTRATION PURPOSES ONLY. DETAILS ARE SUBJECT TO CHANGE.